

Installation Cont.

9

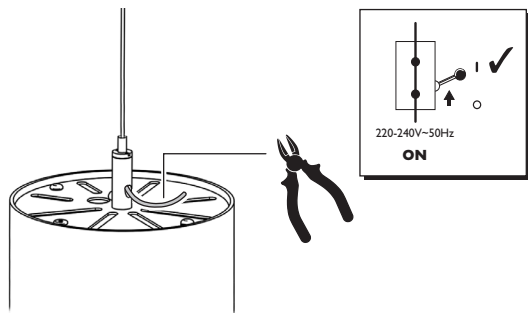

Cut away excess Suspension Wire

Reconnect electricity supply and test the installation

Emergency Battery Replacement

1

Disconnect electricity supply

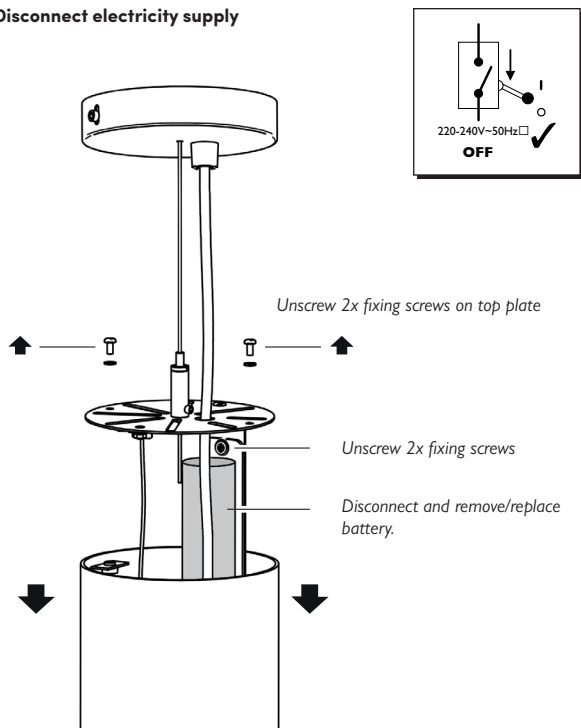

Unscrew 2x fixing screws on top plate

Unscrew 2x fixing screws

Disconnect and remove/replace battery.

Installation Cont.

2

Follow point 1 in reverse to re-install

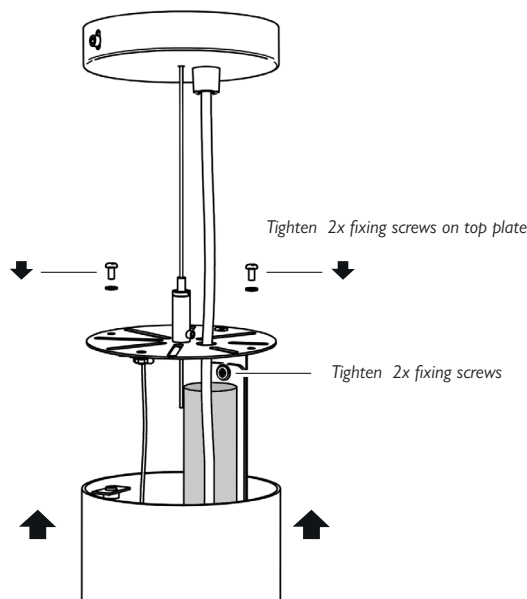

Tighten 2x fixing screws on top plate

Tighten 2x fixing screws

Reconnect electricity supply and test the installation

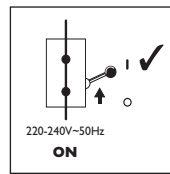

IMPORTANT INFORMATION

Microbezel® 300 Pendant



IMPORTANT INFORMATION

Disconnect electricity supply before installation

To be installed by qualified personnel only and in accordance with current building and wiring regulations.

When installing, we recommend wearing disposable gloves to avoid fingerprinting to the paint work of the luminaire.

Read leaflet fully before installation.



THE SILVERLINK, WALLSEND, NEWCASTLE UPON TYNE, TYNE & WEAR, NE28 9ND

Technical: (0191) 280 9914
Email: technical@hacel.co.uk
Web: www.hacel.co.uk

Preparation

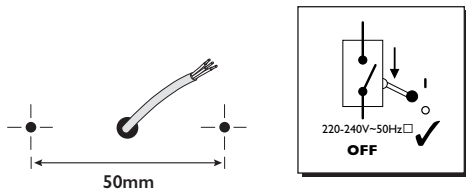

Ensure fixings used are suitable for mounting substrate.

PNI607 = 1.3 kg

Installation

1

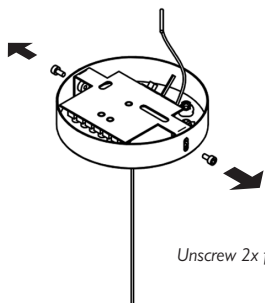

Unscrew 2x fixing screws (keep safe for re-use).

2

Disconnect the Earth Cable from Earth Tab.

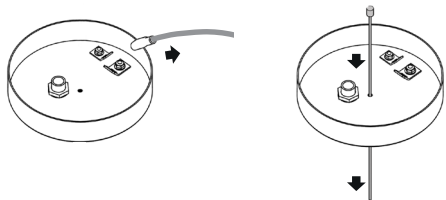

Feed Suspension Wire through Mounting Plate Cover.

Installation Cont.

3

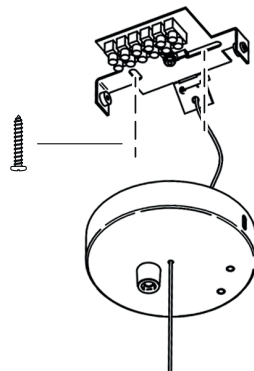

Ensure suitable fixings are used when installing.

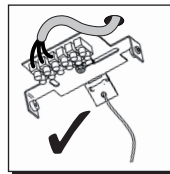

Restrain Mains/Dimming cable with plastic Cable Tie.

4

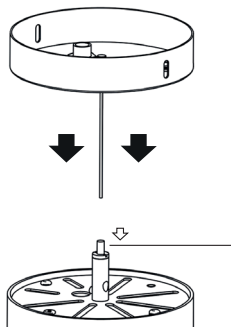

Feed Suspension Wire through Clutch while pushing down on Clutch Neck. Once released, this will support the luminaire temporarily,

5

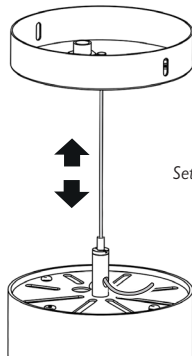

Set the luminaire to required height

Installation Cont.

6

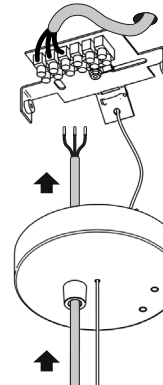

For Mains/Dimming see Connector Block info Label

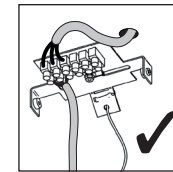

7

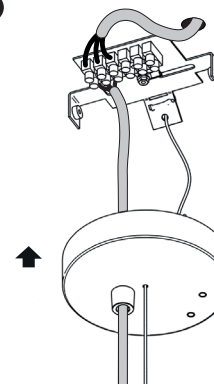

Offer Mounting Plate Cover up to Mounting Plate

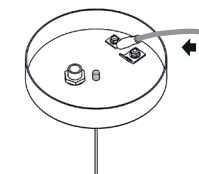

Re-connect the Earth Cable from Earth Tab.

8

